

Composite Cutting Tools

镶PCD镗窝钻 - 带连体式导柱

PCD Tipped Countersinks - Integral Pilot

应用: 碳纤维, 玻璃钢等复合材料

特点: 镶PCD刀片, 寿命长, 孔径光滑, 质量高

波音, 空客认可产品, 高性价比。

PCD Tipped Countersinks, recommended for use on composite materials in which high speed steel will not perform satisfactorily, are specially designed for cutting highly abrasive materials.

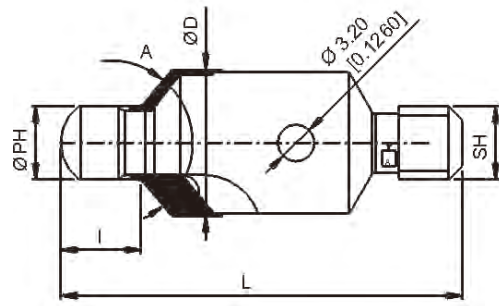

英制

100° / 130°, 螺纹柄, 2 刃

Double Flutes 100°/130° Angle Countersinks Threaded Shank

订购型号 (按镗窝角度) Part Number		(ØD) 刀身直径 (ØD) Body Dia (inch)	(PH) 导孔直径 (PH) Pilot Holes (inch)	刃数 No. of Flutes	螺纹柄 尺寸 Shank Thread
100°	130°				
GPCIP2004125	GPCIP2204125	3/8	0.125	2	1/4"-28
GPCIP2004128	GPCIP2204128	3/8	0.128	2	1/4"-28
GPCIP2005156	GPCIP2205156	7/16	0.156	2	1/4"-28
GPCIP2005187	GPCIP2205187	7/16	0.187	2	1/4"-28
GPCIP2006125	GPCIP2206125	1/2	0.125	2	1/4"-28
GPCIP2006128	GPCIP2206128	1/2	0.128	2	1/4"-28
GPCIP2006239	GPCIP2206239	1/2	0.239	2	1/4"-28
GPCIP2008191	GPCIP2208191	5/8	0.191	2	1/4"-28
GPCIP2008250	GPCIP2208250	5/8	0.25	2	1/4"-28
GPCIP2010312	GPCIP2210312	3/4	0.312	2	3/8"-24
GPCIP2012312	GPCIP2212312	7/8	0.312	2	3/8"-24
GPCIP2014312	GPCIP2214312	1	0.312	2	7/16"-20
GPCIP2018312	GPCIP2218312	1 1/4	0.312	2	7/16"-20

英制

100° / 130°, 螺纹柄, 3 刃

Three Flutes 100°/130° Angle Countersinks Threaded Shank

订购型号 (按镗窝角度) Part Number		(ØD) 刀身直径 (ØD) Body Dia (inch)	(PH) 导孔直径 (PH) Pilot Holes (inch)	刃数 No. of Flutes	螺纹柄 尺寸 Shank Thread
100°	130°				
GPCIP3004125	GPCIP3204125	3/8	0.125	3	1/4"-28
GPCIP3005187	GPCIP3205187	7/16	0.187	3	1/4"-28
GPCIP3006128	GPCIP3206128	1/2	0.128	3	1/4"-28
GPCIP3008191	GPCIP3208191	5/8	0.191	3	1/4"-28
GPCIP3008250	GPCIP3208250	5/8	0.25	3	1/4"-28
GPCIP3010312	GPCIP3210312	3/4	0.312	3	3/8"-24
GPCIP3012312	GPCIP3212312	7/8	0.312	3	3/8"-24
GPCIP3014312	GPCIP3214312	1	0.312	3	7/16"-20
GPCIP3018312	GPCIP3218312	1 1/4	0.312	3	7/16"-20

公制

100° / 130°, 螺纹柄, 2 刃

Double Flutes 100°/130° Angle Countersinks Pilot Threaded Shank

订购型号 (按镗窝角度) Part Number		(ØD) 刀身直径 (ØD) Body Dia (mm)	(PH) 导孔直径 (PH) Pilot Holes (mm)	刃数 No. of Flutes	螺纹柄 尺寸 Shank Thread
100°	130°				
GPCIP2010300	GPCIP2210300	10	3.00	2	M6X1.0
GPCIP2012300	GPCIP2212300	12	3.00	2	M6X1.0
GPCIP2014300	GPCIP2214300	14	3.00	2	M8X1.0
GPCIP2017300	GPCIP2217300	17	4.00	2	M8X1.0
GPCIP2019600	GPCIP2219600	19	6.00	2	M8X1.0
GPCIP2022800	GPCIP2222800	22	8.00	2	M8X1.0
GPCIP2025800	GPCIP2225800	25	8.00	2	M8X1.0

公制

100° / 130°, 螺纹柄, 3 刃

Three Flutes 100°/130° Angle Countersinks Pilot Threaded Shank

订购型号 (按镗窝角度) Part Number		(ØD) 刀身直径 (ØD) Body Dia (mm)	(PH) 导孔直径 (PH) Pilot Holes (mm)	刃数 No. of Flutes	螺纹柄 尺寸 Shank Thread
100°	130°				
GPCIP3010300	GPCIP3210300	10	3.00	3	M6X1.0
GPCIP3012300	GPCIP3212300	12	3.00	3	M6X1.0
GPCIP3014300	GPCIP3214300	14	3.00	3	M8X1.0
GPCIP3017300	GPCIP3217300	17	4.00	3	M8X1.0
GPCIP3019600	GPCIP3219600	19	6.00	3	M8X1.0
GPCIP3022800	GPCIP3222800	22	8.00	3	M8X1.0
GPCIP3025800	GPCIP3225800	25	8.00	3	M8X1.0



Composite Cutting Tools

镶PCD铰窝钻-带可换导柱

PCD Tipped Countersinks - Interchangeable Pilot

- 镶PCD刀片，特别设计用于加工耐磨性强的材料，例如碳纤维复合材料。
- 可换导柱构造，在复合材料铰窝表现出色，特别设计用于钻削耐磨性强的材料。可以在同一个铰窝钻上替换多个不同直径的导柱。高性价比的刀具。
- PCD Tipped Countersinks diamond cutting tools, recommended for use on composite materials in which high speed steel will not perform satisfactorily are specially designed for cutting highly abrasive materials.
- Replaceable pilot construction allows for replacement of damaged pilots and substitution of various pilot diameters with the same countersink.

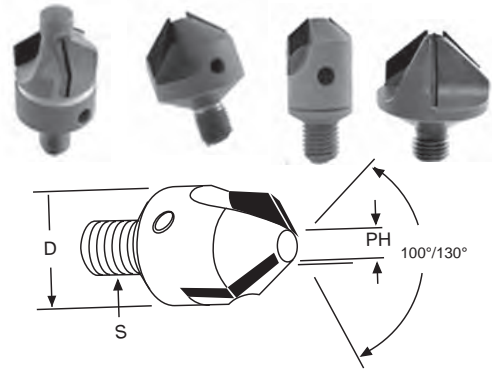

2 刃, 100° / 130°, 可换导柱, 螺纹柄
Double Flutes 100°/130° Angle Countersinks Pilot Threaded Shank

3 刃, 100° / 130°, 可换导柱, 螺纹柄
3 Flutes, 100° / 130° Angle Countersinks, Threaded Shank, Interchangeable Pilot

订购编号 (按铰窝角度) Part Number		(ØD) 刀身直径 (ØD) Body Dia	(PH) 导孔直径 (PH) Pilot Holes	螺纹柄 尺寸 Shank Thread	订购编号 (按铰窝角度) Part Number		(ØD) 刀身直径 (ØD) Body Dia	(PH) 导孔直径 (PH) Pilot Holes	螺纹柄 尺寸 Shank Thread
100°	130°				100°	130°			
GPCRP1204125	GPCRP1604125	3/8"	0.125"	1/4" - 28	GPCRP2406125	GPCRP2606125	1/2"	0.125"	1/4" - 28
GPCRP1206125	GPCRP1606125	1/2"	0.125"	1/4" - 28	GPCRP2408125	GPCRP2608125	5/8"	0.125"	1/4" - 28
GPCRP1208125	GPCRP1608125	5/8"	0.125"	1/4" - 28	GPCRP2410188	GPCRP2610188	3/4"	0.188"	7/16" - 20
GPCRP1210188	GPCRP1610188	3/4"	0.188"	7/16" - 20	GPCRP2412188	GPCRP2612188	7/8"	0.188"	7/16" - 20
GPCRP1212188	GPCRP1612188	7/8"	0.188"	7/16" - 20	GPCRP2414188	GPCRP2614188	1"	0.188"	7/16" - 20
GPCRP1214188	GPCRP1614188	1"	0.188"	7/16" - 20	GPCRP2416188	GPCRP2616188	1 1/4"	0.188"	7/16" - 20
GPCRP1216188	GPCRP1616188	1-1/4"	0.188"	7/16" - 20	GPCRP2510250	GPCRP2710250	10mm	2.50mm	M6X1.0
GPCRP1310250	GPCRP1510250	10mm	2.50mm	M6X1.0	GPCRP2512300	GPCRP2712300	12mm	3.00mm	M6X1.0
GPCRP1312300	GPCRP1512300	12mm	3.00mm	M6X1.0	GPCRP2514300	GPCRP2714300	14mm	3.00mm	M6X1.0
GPCRP1314300	GPCRP1514300	14mm	3.00mm	M6X1.0	GPCRP2517300	GPCRP2717300	17mm	3.00mm	M8X1.0
GPCRP1317300	GPCRP1517300	17mm	3.00mm	M8X1.0	GPCRP2519400	GPCRP2719400	19mm	4.00mm	M8X1.0
GPCRP1319400	GPCRP1519400	19mm	4.00mm	M8X1.0	GPCRP2521400	GPCRP2721400	21mm	4.00mm	M8X1.0
GPCRP1321400	GPCRP1521400	21mm	4.00mm	M8X1.0					

如需其他尺寸，欢迎咨询！ Additional Dimensions Available on Request

镶PCD平底铰钻-带可换导柱

PCD Tipped Counterbores Interchangeable Pilot

- 镶PCD刀片，适合碳纤维，或玻璃钢等复合材料。
- 寿命长，高质量，公制，英制孔径可选



英制

1 刃, 3 刃, 螺纹柄 One/Three flute				
订购型号 Part Number	刀身直径 "D" Body Dia.	导孔直径 "PH" Pilot Hole Dia.	刃数 No. of Flutes	螺纹刀柄尺寸 Shank Size
GPCBR1604125	3/8"	0.125"	1	1/4"-28
GPCBR1606125	1/2"	0.125"	1	1/4"-28
GPCBR1608125	5/8"	0.125"	1	1/4"-28
GPCBR3604125	3/8"	0.125"	3	1/4"-28
GPCBR3606125	1/2"	0.125"	3	1/4"-28
GPCBR3608125	5/8"	0.125"	3	1/4"-28

公制

1 刃, 3 刃, 螺纹柄 One/Three flute				
订购型号 Part Number	刀身直径 "D" Body Dia.	导孔直径 "PH" Pilot Hole Dia.	刃数 No. of Flutes	螺纹刀柄尺寸 Shank Size
GPCBR1510250	10	2.50	1	M6X1.0
GPCBR1512300	12	3.00	1	M6X1.0
GPCBR1514300	14	3.00	1	M6X1.0
GPCBR3510250	10	2.50	3	M6X1.0
GPCBR3512300	12	3.00	3	M6X1.0
GPCBR3514300	14	3.00	3	M6X1.0

如需其他尺寸，欢迎咨询！ Additional Dimensions Available on Request



PCD钻头 Helicon PCD Full Nib Drill



全PCD钻尖特殊设计，用于以下材料制孔：
 复合材料
 叠层材料，诸如复材+铝合金，复材+钛合金，复材+铝合金+钛合金
 锋利钻尖，刺穿阻力小，极大减少复材分层。
 制孔干净利落。
 采用螺旋刀槽，获得更好排屑效果。
 更长的寿命。
 从钻第一个孔到刀具报废，保持孔表面光洁度和尺寸稳定性，制孔效果有始有终。
 钻头均可修磨，平均制孔成本明显优于其他PCD和CVD钻头。
 全系列PCD钻头——交货周期短
 PCD钻头尺寸：从1.7mm到10mm

First in market PCD Full Nib Drill special design for Hole making in:
 CFRP
 CFRP/Metal stacks like CFRP/Aluminium, CFRP/Titanium, CFRP/AL/TI
 Minimum delamination by low penetration forces
 Clean exit at hole
 Optimal chip evacuation by use of spiral flutes
 Longer Tool Life
 Hole surface finish and dimension stability from first hole during entire tool life
 These drills can be resharpened, which outperforms other PCD and CVD drills at a significant cost saving
 Full range of PCD Full Nib Drills – short delivery time
 PCD Full Nib Drill diameter range: from 1.7mm to 10mm
 This Special designed point is for use in all thicknesses of Kevlar Laminates.
 The unusual geometry of this tool eliminates breakout and delamination of the material being drilled.

实际钻孔测试举例 Test examples: Aerospace components



竞争对手钻头
Competitor Drill



PCD钻头
Our PCD Drill

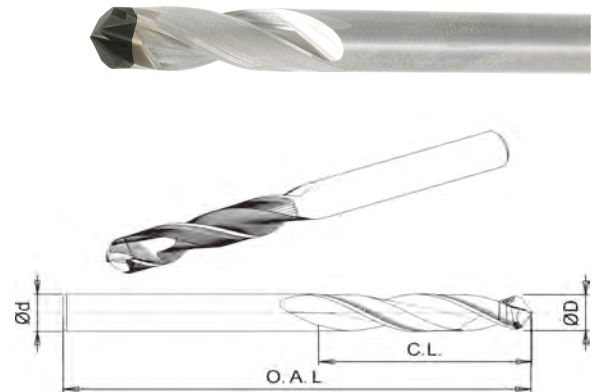

英制

PCD 钻头	PCD Full Nib Spiral Drills			
订购编号 Part#	直径 Diameter Ø D	柄径 Shank Ø d	钻头长度 Cutting Length	总长 Overall Length
GPFND _____	from 0.0980" to 0.1250"	0.125 (1/8")	1.02"	2.44"
GPFND _____	from 0.1250" to 0.1875"	0.1875 (3/16")	1.02"	2.44"
GPFND _____	from 0.1880" to 0.2500"	0.250 (1/4")	1.22"	2.76"
GPFND _____	from 0.2540" to 0.3125"	0.3125 (5/16")	1.46"	3.11"
GPFND _____	from 0.3130" to 0.3540"	0.3750 (3/8")	1.69"	3.50"

订购型号举例：

例如钻头直径为0.1250，订购型号就是FND-1250

可供应带内冷孔款式。

*如需其他尺寸，欢迎咨询！

Sample: For a Full-Nib Drill with C.D of 0.1250: FND-1250

*Additional Dimensions Available On Request.

Available with Coolant through Holes

公制

PCD 钻头	PCD Full Nib Spiral Drills			
订购编号 Part#	直径 Diameter Ø D (mm)	柄径 Shank Ø d (mm)	钻头长度 Cutting Length (mm)	总长 Overall Length (mm)
GPFND _____	from 2.50 to 3.00	3.0	16.0	60.0
GPFND _____	from 3.01 to 4.00	4.0	22.0	75.0
GPFND _____	from 4.01 to 5.00	5.0	26.0	75.0
GPFND _____	from 5.01 to 6.00	6.0	28.0	80.0
GPFND _____	from 6.01 to 7.00	8.0	37.0	85.0
GPFND _____	from 7.01 to 8.00	8.0	37.0	85.0
GPFND _____	from 8.01 to 9.00	10.0	43.0	90.0
GPFND _____	from 9.01 to 10.00	10.0	43.0	90.0

进给率 Feedrate (mm/th)	线速度 Speed (m/min)	被加工材料 Material Group
0.02-0.45	150-200	CFRP
0.02-0.45	150-200	CFRP/AI
0.02-0.075	10-15	CFRP/TI

公英制尺寸转换表，请见最后一页



客服热线：+86-21-6226 7999

• 传真：+86-21-6226 6255

• E-mail: sales@grand-pacific.cn

Composite Cutting Tools

镶PCD钻头

PCD Spiral Drills

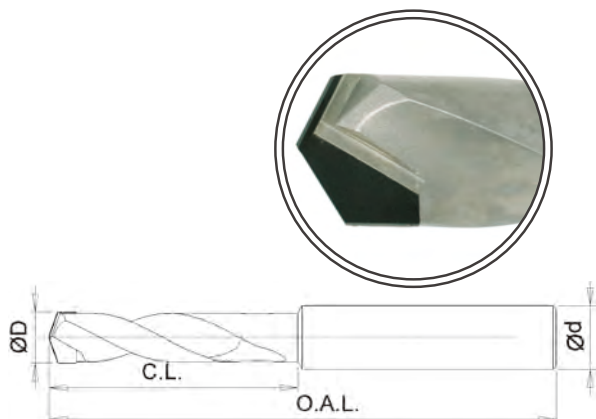

公制

订购编号 Part#	直径 Diameter Ø D (mm)	柄径 Shank Ø d (mm)	钻头长度 Cutting Length (mm)	总长 Overall Length (mm)
GPTSD-	3.00	3.0	16.0	46.0
GPTSD-	3.01 到 4.00	4.0	22.0	55.0
GPTSD-	4.01 到 5.00	5.0	26.0	62.0
GPTSD-	5.01 到 6.00	6.0	28.0	66.0
GPTSD-	6.01 到 7.00	7.0	34.0	74.0
GPTSD-	7.01 到 8.00	8.0	37.0	79.0
GPTSD-	8.01 到 9.00	9.0	40.0	84.0
GPTSD-	9.01 到 10.00	10.0	43.0	89.0
GPTSD-	10.01 到 11.00	11.0	47.0	95.0
GPTSD-	11.01 到 12.00	12.0	51.0	102.0
GPTSD-	12.01 到 13.00	13.0	51.0	102.0
GPTSD-	13.01 到 14.00	14.0	54.0	107.0
GPTSD-	14.00 到 15.00	15.0	56.0	111.0
GPTSD-	15.01 到 16.00	16.0	58.0	115.0

英制

订购编号 Part#	直径 Diameter Ø D (inch)	柄径 Shank Ø d (inch)	钻头长度 Cutting Length (inch)	总长 Overall Length (inch)
GPTSD-	0.1250 到 0.1875	0.1875 (3/16")	1.02	2.44
GPTSD-	0.1880 到 0.2500	0.250 (1/4")	1.22	2.76
GPTSD-	0.2540 到 0.3125	0.3125 (5/16")	1.46	3.11
GPTSD-	0.3130 到 0.3750	0.3750 (3/8")	1.69	3.50
GPTSD-	0.3800 到 0.4375	0.4375 (7/16")	1.85	3.74
GPTSD-	0.4380 到 0.5000	0.5000 (1/2")	2.01	4.02

订购型号举例：

例如钻头直径为6.0，订购型号就是GPTSD-0600

如需其他尺寸，欢迎咨询！

Additional Dimensions Available on Request

For a Spiral Drill with C.D of 6.0: GPTSD-0600

铰刀，整体硬质合金，螺纹柄

Solid Carbide Threaded Shank Reamers

航空专用 高质量

长系列，带导柱，直刃，右切

GP829-0 硬质合金

Long Series, Threaded Shank Reamers

Piloted, Straight Flute, Right Hand Cut

GP829-0 Carbide



订购型号 硬质合金829-0 EDP# Carbide 829-0	尺寸范围 Size Range (inch)	总长* Overall* Length (inch)	最小导柱 直径 Min. Pilot Dia. (inch)	颈口直径 Neck Dia. (inch)	螺纹长度 Thread Length (inch)	六角尺寸 Hex Size (inch)
GP82900	0.1500-0.1632	2-1/8	0.125	Body	0.250	5/16
GP82901	0.1633-0.1789	2-1/8	0.137	Body	0.250	5/16
GP82902	0.1790-0.1945	2-1/8	0.150	Body	0.250	5/16
GP82903	0.1946-0.2101	2-1/8	0.162	Body	0.250	5/16
GP82904	0.2102-0.2258	2-1/8	0.174	0.205	0.250	5/16
GP82905	0.2259-0.2414	2-1/8	0.187	0.220	0.250	5/16
GP82906	0.2415-0.2570	2-1/8	0.200	0.235	0.250	5/16
GP82907	0.2571-0.2720	2-1/8	0.212	0.245	0.250	5/16
GP82908	0.2721-0.2880	2-1/8	0.225	0.250	0.250	5/16
GP82909	0.2881-0.3040	2-1/8	0.237	0.280	0.250	5/16
GP82910	0.3041-0.3190	2-1/8	0.256	0.280	0.250	5/16
GP82911	0.3191-0.3350	2-1/8	0.262	0.280	0.250	3/8
GP82912	0.3351-0.3479	2-1/8	0.275	0.280	0.250	3/8
GP82913	0.3480-0.3660	2-1/8	0.278	0.307	0.250	3/8
GP82914	0.3661-0.3820	2-1/8	0.300	0.307	0.250	3/8
GP82915	0.3821-0.3980	2-1/8	0.312	0.307	0.250	3/8
GP82916	0.3981-0.4129	2-1/8	0.324	0.307	0.250	3/8

总长是测量从螺纹与六角连接弯角处到铰刀顶端的距离。

Overall length is measured from seating angle to tip.



PCD 钻铤复合钻 PCD Drill Countersinks

应用：机器人制孔，和自动进给钻用。碳纤维复合材料钻孔
 特点：钻孔，铤窝一刀完成，高效率，低成本。
 可选用螺纹柄或直柄

Drilling and Countersinking in one pass.
 For use on machines with controlled feed
 Available with threaded or plain shanks

镶PCD钻头

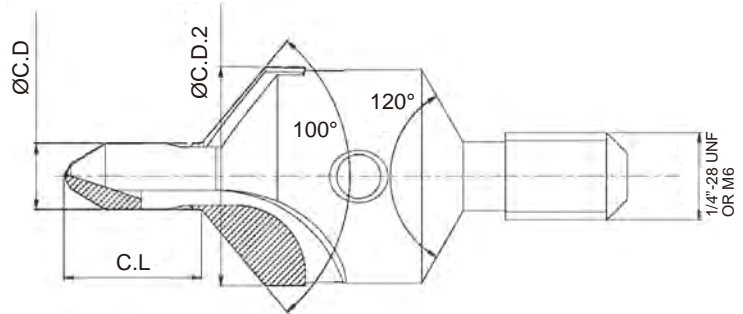
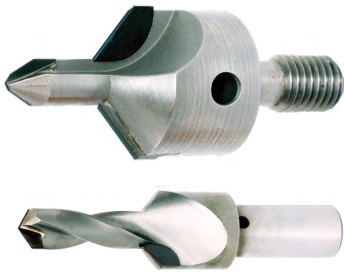

如需其他尺寸，欢迎咨询！可供应带内冷孔款式
 Available with Coolant through Holes, Available with Coolant through Holes
 订购型号举例：
 例如钻头直径为0.25"钻铤复合钻，订购型号就是GPWCDR-2500
 For a Wafer C'Drill with C.D of 0.25" : GPWCDR-2500

订购型号 Part#	钻头直径 Diameter Ø C.D.	柄径 Shank Ø d	铤窝直径 Diameter C.D2.	铤窝角度 Angel deg.
GPWCDR-___	0.1250" 到 0.2500"	3/8"	3/8"	100°
GPWCDR-___	0.2540" 到 0.3750"	1/2"	1/2"	100°
GPWCDR-___	0.3800" 到 0.5000"	1/2"	3/4"	100°

全PCD钻头

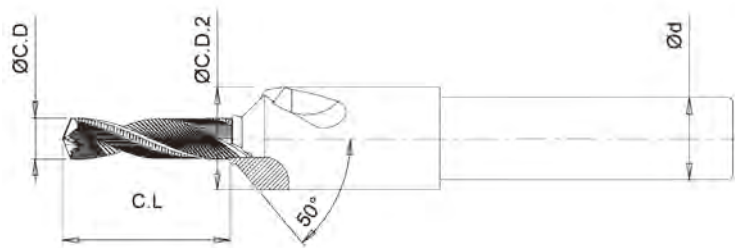
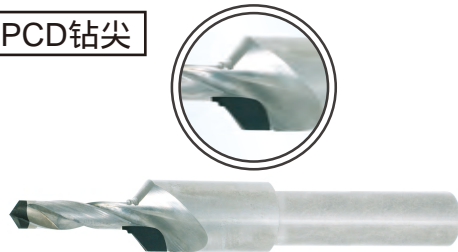

如需其他尺寸，欢迎咨询！可供应带内冷孔款式
 Available with Coolant through Holes, Available with Coolant through Holes
 订购型号举例：
 例如钻头直径为0.25"全PCD钻头钻铤复合钻，
 订购型号就是GPFCDR-2500
 For a Full Nib C'Drill with C.D of 0.25" : GPFCDR-2500

订购型号 Part#	钻头直径 Diameter Ø C.D.	柄径 Shank Ø d	铤窝直径 Diameter C.D2.	铤窝角度 Angel deg.
GPFCDR-___	0.0980" 到 0.2500"	3/8"	3/8"	100°
GPFCDR-___	0.2540" 到 0.3125"	1/2"	1/2"	100°
GPFCDR-___	0.3130" 到 0.3540"	1/2"	3/4"	100°

镶PCD阶梯钻铤 PCD Step Drill Reamer

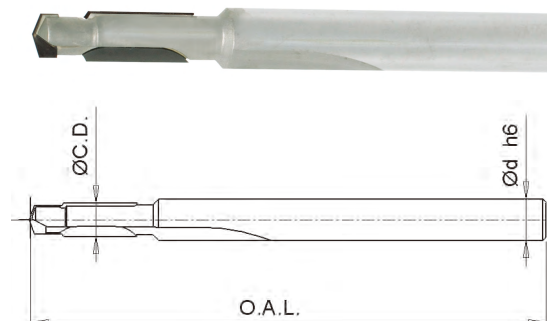

公制

订购编号 Part#	直径 Diameter Ø D (mm)	柄径 Shank Ø d (mm)	总长 OAL (mm)
GPSDR-___	from 4.88 to 6.40	6.0	100.0
GPSDR-___	from 6.45 to 8.40	8.0	100.0
GPSDR-___	from 8.45 to 10.40	10.0	100.0
GPSDR-___	from 10.45 to 12.40	12.0	100.0

如需其他尺寸，欢迎咨询！Additional Dimensions Available on Request

订购方式举例：例如直径为4.88mm且柄径为6.0mm的PCD阶梯钻铤，
 订购型号就是SDR-0488-0600
 For drill with D=4.88 and shank=6.0 : SDR-0488-0600.

铣刀》镶PCD刀片》螺旋刃 Spiral Vein PCD End Mills

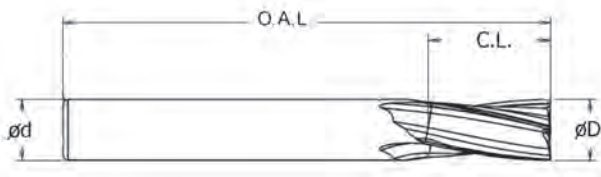

英制

订购型号 Part#	直径 Cutter Dia. (inch)	刃长 Cutting Length (inch)	柄径 Shank Dia. (inch)	螺旋角 Helix Angel (inch)	总长 Overall Length (inch)	刃数 Flutes
GPVEM-025-15-R/L	1/4	1/2	1/4	15	2.72	2
GPVEM-0375-15-R/L	3/8	3/4	3/8	15	3.22	4
GPVEM-05-15-R/L	1/2	3/4	1/2	15	3.47	4

3/8"或更大直径时可供带内冷孔款式, 选购时请在订购型号后加H, 例如GPVEM-05-30-R-H
 Sizes 3/8" or larger have an option for a coolant hole. Use an "H" at the end of the part number (e.g. GPVEM-05-30-R-H).

公制

订购型号 Part#	直径 Cutter Dia. (mm)	刃长 Cutting Length (mm)	柄径 Shank Dia. (mm)	螺旋角 Helix Angel (mm)	总长 Overall Length (mm)	刃数 Flutes
GPVEM-06-15-R/L	6.0	12.7	6.0	15	68.5	2
GPVEM-08-15-R/L	8.0	19.0	8.0	15	81.0	4
GPVEM-10-15-R/L	10.0	19.0	10.0	15	81.0	4
GPVEM-12-15-R/L	12.0	19.0	12.0	15	87.5	4

10mm或更大直径时可供带内冷孔款式, 选购时请在订购型号后加H, 例如GPVEM-12-15-R-H
 Sizes 10mm or larger have an option for a coolant hole. Use an "H" at the end of the part number (e.g. GPVEM-12-15-R-H).

铣刀》镶PCD》直刃 Standard PCD Flat End Mills

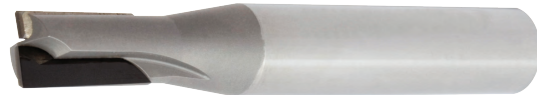
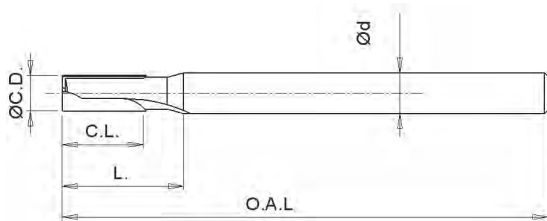

如需其他尺寸, 欢迎咨询! Additional Dimensions Available on Request

英制

订购型号 Part#	直径 Cutter Dia. (inch)	刃长 Cutting Length (inch)	柄径 Shank Dia. (inch)	L	总长 Overall Length (inch)	刃数 No. of Flutes	材质 Tool Body
GPFO-510-04	1/8	1/4	1/8	3/8	1 1/2	1	W.C.
GPFO-510-06	3/16	5/16	3/16	7/16	2.0	1	W.C.
GPFO-510-08	1/4	3/8	1/4	9/16	2.0	2	W.C.
GPFO-510-12	3/8	1/2	3/8	5/8	2 1/2	2	W.C.
GPFO-510-16	1/2	5/8	1/2	1 1/4	3.0	2	W.C.
GPFO-510-20	5/8	7/8	5/8	1 1/4	3 1/4	2	W.C.
GPFO-515-20	5/8	7/8	5/8	1 1/4	3 1/4	2	Steel
GPFO-510-24	3/4	1.0	3/4	1 1/2	4.0	2	W.C.
GPFO-515-24	3/4	1.0	3/4	1 1/2	4.0	2	Steel

公制

订购型号 Part#	直径 Cutter Dia. (mm)	刃长 Cutting Length (mm)	柄径 Shank Dia. (mm)	L	总长 Overall Length (mm)	刃数 No. of Flutes	材质 Tool Body
GPFO-610-03	3.0	6.0	3.0	9.0	60.0	1	W.C.
GPFO-610-04	4.0	6.0	4.0	9.0	60.0	1	W.C.
GPFO-610-05	5.0	8.0	5.0	12.0	60.0	1	W.C.
GPFO-610-06	6.0	10.0	6.0	14.0	75.0	2	W.C.
GPFO-615-06	6.0	15.0	6.0	19.0	75.0	2	W.C.
GPFO-610-08	8.0	10.0	8.0	15.0	75.0	2	W.C.
GPFO-615-08	8.0	15.0	8.0	20.0	75.0	2	W.C.
GPFO-610-10	10.0	15.0	10.0	20.0	75.0	2	W.C.
GPFO-610-12	12.0	15.0	12.0	20.0	75.0	2	W.C.
GPFO-610-16	16.0	20.0	16.0	25.0	100.0	2	W.C.
GPFO-615-16	16.0	20.0	16.0	25.0	100.0	2	Steel
GPFO-610-20	20.0	25.0	20.0	30.0	100.0	2	W.C.
GPFO-615-20	20.0	25.0	20.0	30.0	100.0	2	Steel

※ 公英制尺寸转换表, 请见最后一页



客服热线: +86-21-6226 7999

• 传真: +86-21-6226 6255

• E-mail: sales@grand-pacific.cn

Composite Cutting Tools

铣刀》镶PCD》多刃

Standard Multi Flute PCD Flat End Mills

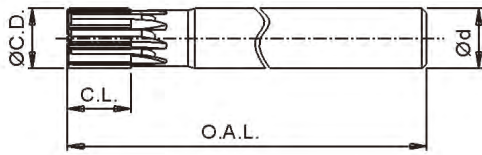

英制

订购型号 Part#	直径 Cutter Dia. (inch)	刃长 Cutting Length (inch)	柄径 Shank Dia. (inch)	L	总长 Overall Length (inch)	刃数 No. of Flutes	材质 Tool Body
GPMO-510-05-3	3/16	1/4	3/16	11/16	2 3/8	3	W.C.
GPMO-510-08-3	5/16	7/16	5/16	11/16	2 3/8	3	W.C.
GPMO-510-10-3	3/8	1/2	3/8	3/4	2 1/2	3	W.C.
GPMO-510-10-4	3/8	1/2	3/8	3/4	3	5	W.C.
GPMO-510-12-3	1/2	1/2	1/2	3/4	3	3	W.C.
GPMO-510-12-5	1/2	1/2	1/2	3/4	3	5	W.C.
GPMO-510-12-7	1/2	1/2	1/2	3/4	3	7	W.C.
GPMO-510-12-9	1/2	1/2	1/2	3/4	3	9	W.C.
GPMO-510-16-3	5/8	5/8	5/8	7/8	3 1/8	3	W.C.
GPMO-510-16-5	5/8	5/8	5/8	7/8	3 1/8	5	W.C.
GPMO-510-16-7	5/8	5/8	5/8	7/8	3 1/8	7	W.C.
GPMO-510-16-9	5/8	5/8	5/8	7/8	3 1/8	9	W.C.

公制

订购型号 Part#	直径 Cutter Dia. (mm)	刃长 Cutting Length (mm)	柄径 Shank Dia. (mm)	L	总长 Overall Length (mm)	刃数 No. of Flutes	材质 Tool Body
GPMO-610-04-3	4.0	6.0	4.0	19.0	50.0	3	W.C.
GPMO-610-06-3	6.0	6.0	6.0	18.0	60.0	3	W.C.
GPMO-610-08-3	8.0	11.0	8.0	13.0	61.0	3	W.C.
GPMO-610-08-4	8.0	10.0	8.0	19.0	75.0	3	W.C.
GPMO-610-10-3	10.0	13.0	10.0	15.0	63.0	3	W.C.
GPMO-610-10-5	10.0	13.0	10.0	15.0	63.0	5	W.C.
GPMO-610-12-3	12.0	13.0	12.0	15.0	75.0	3	W.C.
GPMO-610-12-5	12.0	13.0	12.0	15.0	75.0	5	W.C.
GPMO-610-12-7	12.0	13.0	12.0	15.0	75.0	7	W.C.
GPMO-610-12-9	12.0	13.0	12.0	15.0	75.0	9	W.C.
GPMO-610-16-3	16.0	16.0	16.0	19.0	79.0	3	W.C.
GPMO-610-16-5	16.0	16.0	16.0	19.0	79.0	5	W.C.
GPMO-610-16-7	16.0	16.0	16.0	19.0	79.0	7	W.C.
GPMO-610-16-9	16.0	16.0	16.0	19.0	79.0	9	W.C.

如需其他尺寸，欢迎咨询！Additional Dimensions Available on Request

铣刀》镶PCD》球头

Standard Flute PCD Ball End Mills

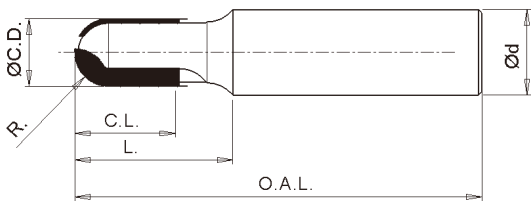

英制

订购型号 Part#	直径 Cutter Dia. (inch)	刃长 Cutting Length (inch)	柄径 Shank Dia. (inch)	刀头 半径 R (inch)	L	总长 Overall Length (inch)	刃数 No. of Flutes	材质 Tool Body
GPBO-510-04	1/8	1/4	1/8	1/16	3/8	1 1/2	1	W.C.
GPBO-510-06	3/16	5/16	3/16	3/32	7/16	2.0	1	W.C.
GPBO-510-08	1/4	3/8	1/4	1/8	9/16	2.0	2	W.C.
GPBO-510-12	3/8	1/2	3/8	3/16	5/8	2 1/2	2	W.C.
GPBO-510-16	1/2	5/8	1/2	1/4	1 1/4	3.0	2	W.C.
GPBO-510-20	5/8	7/8	5/8	5/16	1 1/4	3 1/4	2	W.C.
GPBO-515-20	5/8	7/8	5/8	5/16	1 1/4	3 1/4	2	Steel
GPBO-510-24	3/4	1.0	3/4	3/8	1 5/8	4.0	2	W.C.
GPBO-515-24	3/4	1.0	3/4	3/8	1 5/8	4.0	2	Steel

公制

订购型号 Part#	直径 Cutter Dia. (mm)	刃长 Cutting Length (mm)	柄径 Shank Dia. (mm)	刀头 半径 R (mm)	L	总长 Overall Length (mm)	刃数 No. of Flutes	材质 Tool Body
GPBO-610-03	3.0	6.0	3.0	1.5	9.0	60.0	1	W.C.
GPBO-610-04	4.0	6.0	4.0	2.0	9.0	60.0	1	W.C.
GPBO-610-05	5.0	8.0	5.0	2.5	12.0	60.0	2	W.C.
GPBO-610-06	6.0	10.0	6.0	3.0	14.0	75.0	2	W.C.
GPBO-615-06	6.0	15.0	6.0	3.0	19.0	75.0	2	W.C.
GPBO-610-08	8.0	10.0	8.0	4.0	15.0	75.0	2	W.C.
GPBO-615-08	8.0	15.0	8.0	4.0	20.0	75.0	2	W.C.
GPBO-610-10	10.0	15.0	10.0	5.0	20.0	75.0	2	W.C.
GPBO-610-12	12.0	15.0	12.0	6.0	20.0	75.0	2	W.C.
GPBO-610-16	16.0	20.0	16.0	8.0	25.0	100.0	2	W.C.
GPBO-615-16	16.0	20.0	16.0	8.0	25.0	100.0	2	Steel
GPBO-610-20	20.0	25.0	20.0	10.0	30.0	100.0	2	W.C.
GPBO-615-20	20.0	25.0	20.0	10.0	30.0	100.0	2	Steel

如需其他尺寸，欢迎咨询！Additional Dimensions Available on Request

